

# MTPReel™ -O

## ENGEL

sumcab  
ROBOTICS

The automatic cable retraction system  
for improved workplace safety

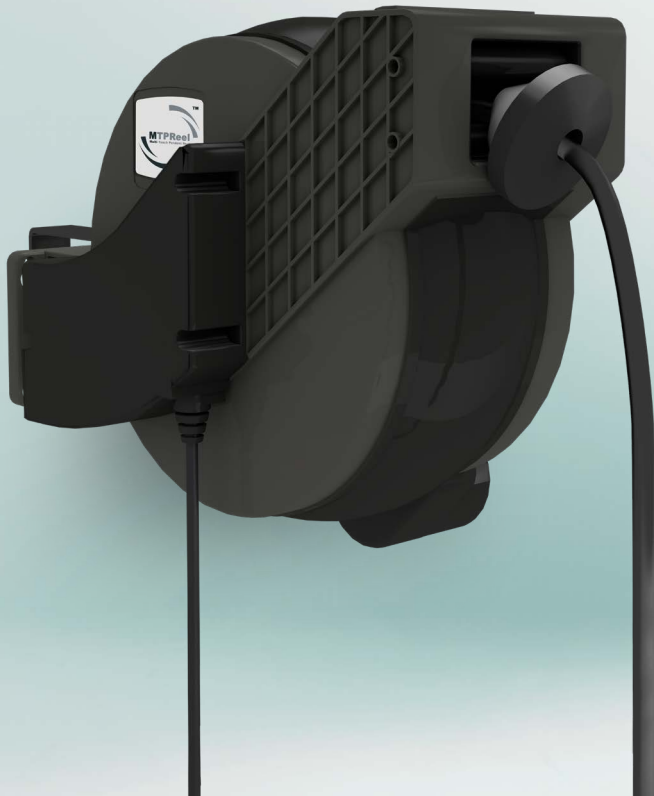

Exclusive sale via  
ENGEL AUSTRIA GmbH

ENGEL



### Time saving

Time is an essential success factor within the industrial sector and the MTPReel helps to save time due to its intuitive operation. The rapid but careful rewinding of the connector cable saves time, which your employees can dedicate to other things.



### Operating error avoidance

Using the MTPReel will ensure that the operating device is assigned unambiguously to the operator. Lengthy searches for the correct plug-in piece and potential operating errors due to incorrect combinations are avoided.



### Plant safety optimisation

Properly storing the connector cable in the MTPReel protects it from dirt and accidental damage, which significantly increases its service life and improves safety within the operational facility.



### Patented and tested system – made in Italy

Our partner company in Italy manufactures the MTPReel to the highest quality standards.



### Safety First

Hazardous situations, such as trip hazards or cable damage, are now a thing of the past.



## Technical specifications

Robot control	Box size	Extension length	Cabinet connection	Dimensions (mm)	Weight (kg)
C10 FSOE	Exclusive extraction cable*	20 m	3 m	434x227x306	4,5kg
C30- C35 , C70 E15 FSOE, C70 ED 10 , C100E	Inclusive extraction cable	15 m	5 m	322x219x276	9kg

\* The MTPReel-0 will be delivered without extendable cable. The original ENGEL C10 power cable can be pluggable connected. Mounting components are included in the delivery.

## Open

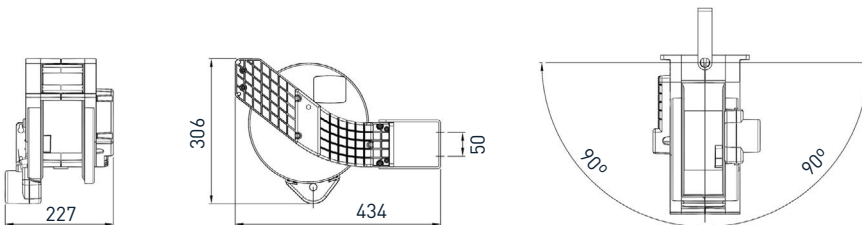

The **MTPReel** is available for **C10 FSOE, C30-C35, C70 E15 FSOE, C70 ED10, C100E** from **ENGEL**.



C70



C10

### ⊕ Extras

- Housing made of shock-resistant material
- Stable, rotatable mounting bracket
- Integrated brake module for a careful cable retraction
- Spring loaded cable retraction system
- Detachable automatic cable release and retraction brake every 50 cm
- Rotating contact transmission system for secure data transmission

### ⊕ Accessories

#### Installation element

- Profile tube stands (rigid or rotatable)
- Control cabinet fixing plates, aluminium profiles or fence elements

#### Connection and extension cables

- 10 m and 20 m connection cables available for all MTPReels
- 10 m, 15 m and 20 m extension cables available for all MTPReels

# MTPReel™ - O Installation Guide



**1**  
Passing the original connecting cable through the guide rollers.



**2**  
Plugging in the cable to the built-in male connector.



**3**  
Free adjustment of the strain relief.



**4**  
Closure of the cable tie around the cable outer jacket.



**5**  
Cutting off the excess cable tie.



**6**  
Inserting the plug cover.



**7**  
Locking the cover by pressing it down.



**8**  
Final cable installation.



**9**  
Attaching the cable pull stopper to the connection cable, mounting it approximately 1-1.5 meters away from the handheld device.



**10**



**11**  
Loosening the nut from the locking pin of the pre-tensioned drum reel.



**12**  
Initial manual winding of the connecting cable.



**13**  
Attaching the cover at the rear to the installed cover guide.



**14**  
Inserting the middle guide tabs by initially attaching the cover at a slight angle from the side and then final snapping into place.



**Sumcab  
Specialcable GmbH**

Allmendstraße 5/1  
74629 Pfedelbach  
Deutschland

T: +49 7941 646 70 0  
F: +49 7941 646 70 10

**Sumcab Specialcable  
Group, S.L.**

Pol. Ind. Pla de Llerona  
08520 Les Franqueses del  
Valles Barcelona - Spain

T: +34 93 381 92 36  
F: +34 93 462 09 22

**The small change  
that changes  
everything**



**MTPReel™**  
Multi Teach Pendant Reel

[www.sumcab.de](http://www.sumcab.de) | [vertrieb@sumcab.de](mailto:vertrieb@sumcab.de)

Sumcab Robotics - DE - 11/2023